

STEP 1

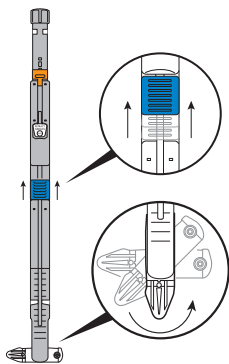

Move **BLUE** slider up to rotate T-Bar and insert into the body

STEP 2

(Optional anesthesia injection)

a) Pull up so T-Bar is against peritoneum



b) Confirm needles will not penetrate skin



c) Press plunger down to 1st click



d) Inject in either or both holes

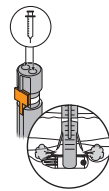

STEP 3

a) Flip **ORANGE** stopper down

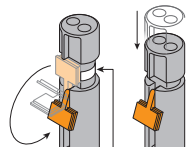

b) Press plunger fully down until it clicks

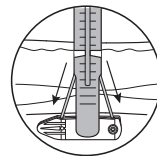

White line **should not** be visible after step 3

STOP

Confirm plunger is fully down

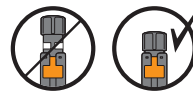

STEP 4

a) Firmly insert advancer tip into either hole

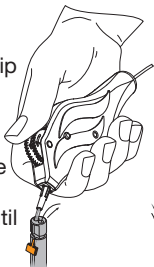

b) Advance wheel forward until guidewire exits the other hole

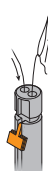

c) Feed 3"- 4" tail of suture through loop

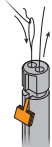

d) Pull guidewire out completely

STEP 5

a) Press **WHITE** button to retract needles

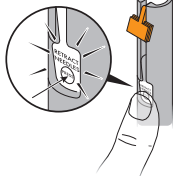

b) Advance M-Close slightly inside body

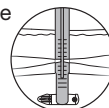

c) Move **BLUE** slider up

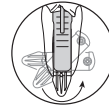

d) Remove from body

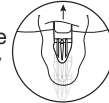

M-CLOSE
KIT

(888) - 700 - 8890  www.NewWaveEndo.com



**TO VIEW SHORT
INSTRUCTIONAL
VIDEO**

NEW WAVE ENDO

OPTIONAL TECHNIQUE FOR THIN ABDOMINAL WALLS

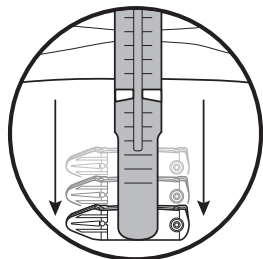

1) Advance M-Close until the white line and needle exit opening are visible inside the body

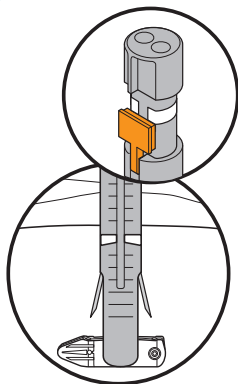

2) Press the plunger down until the plunger's white line meets the top of the orange stopper. You will see the needles partially exit M-Close without entering the tissue

3) While keeping the plunger in place (with the white line remaining over the top of the orange stopper), pull upwards on M-Close until the T-Bar is flat against the peritoneum

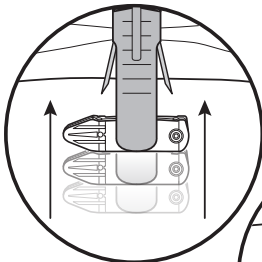

4) Once pulled fully upwards, press the plunger to the first click and proceed as normal

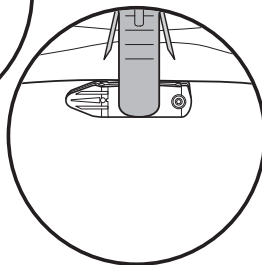

M-CLOSE™
KIT

(888) - 700 - 8890

www.NewWaveEndo.com



**TO VIEW SHORT
INSTRUCTIONAL VIDEO**

NEW WAVE ENDO